

RESOLUTION NO. 22-52

**RESOLUTION EXPANDING RURAL SPECIAL
IMPROVEMENT MAINTENANCE DISTRICT #815M
(DEWIT SUBDIVISION)**

WHEREAS, pursuant to §7-12-2161(4), MCA, the Commissioners have the power of changing, by resolution, the boundaries of any maintenance district not more than once a year; and

WHEREAS the boundaries of RSID 815M have not been changed within the last year; and

WHEREAS, it has been determined that properties adjacent to the existing Rural Special Improvement District #815M boundaries are benefited properties accessing the dry hydrant; and

WHEREAS, the benefited property status requires the expansion of boundaries for RSID 815M for the maintenance of the dry hydrant located within the district boundaries; and

WHEREAS, the boundaries of the district will be expanded to include tax codes C17593-C17605, C17620-C17644, C17650 and C17652-C17663, Yellowstone County, Montana, and

WHEREAS, lots to be added to the district and boundaries of the expanded district are shown in Exhibit A (map).

NOW, THEREFORE, BE IT RESOLVED by the Board of County Commissioners of Yellowstone County, Montana, deeming the public interest or convenience require, intends to expand the following described Rural Special Improvement Maintenance District:

1. **DESCRIPTION OF IMPROVEMENTS, DESCRIPTION OF MAINTENANCE, METHOD OF ASSESSMENT AND ESTIMATED COSTS.** Assessments collected on behalf of this district shall be used for the maintenance of the dry hydrant located within the boundaries of this district. All of the costs of the district shall be assessed equally on a per lot method for existing and future lots. Assessments will be established annually by the Board of County Commissioners and are subject to adjustment due to cost fluctuations related to maintenance utilization levels and changes in material and labor costs of performing necessary maintenance.
2. **DURATION.** The district shall be deemed to be perpetual in nature unless absorbed and replaced by another district or municipality.



Page 2
Resolution Expanding
RSID #815M

PASSED AND ADOPTED by the Board of County Commissioners of Yellowstone
County, Montana, this 9th of August, 2022.

BOARD OF COUNTY COMMISSIONERS
YELLOWSTONE COUNTY, MONTANA



Donald W. Jones, Chairman

John Ostlund, Member
Denis Pitman, Member

(SEAL)

ATTEST:

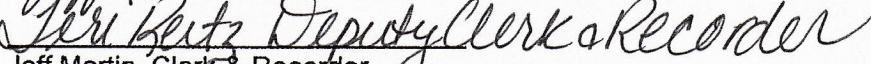
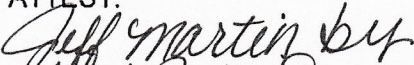

Jeff Martin, Clerk & Recorder
Yellowstone County, Montana

EXHIBIT A

RSID 815M
New Expansion Area

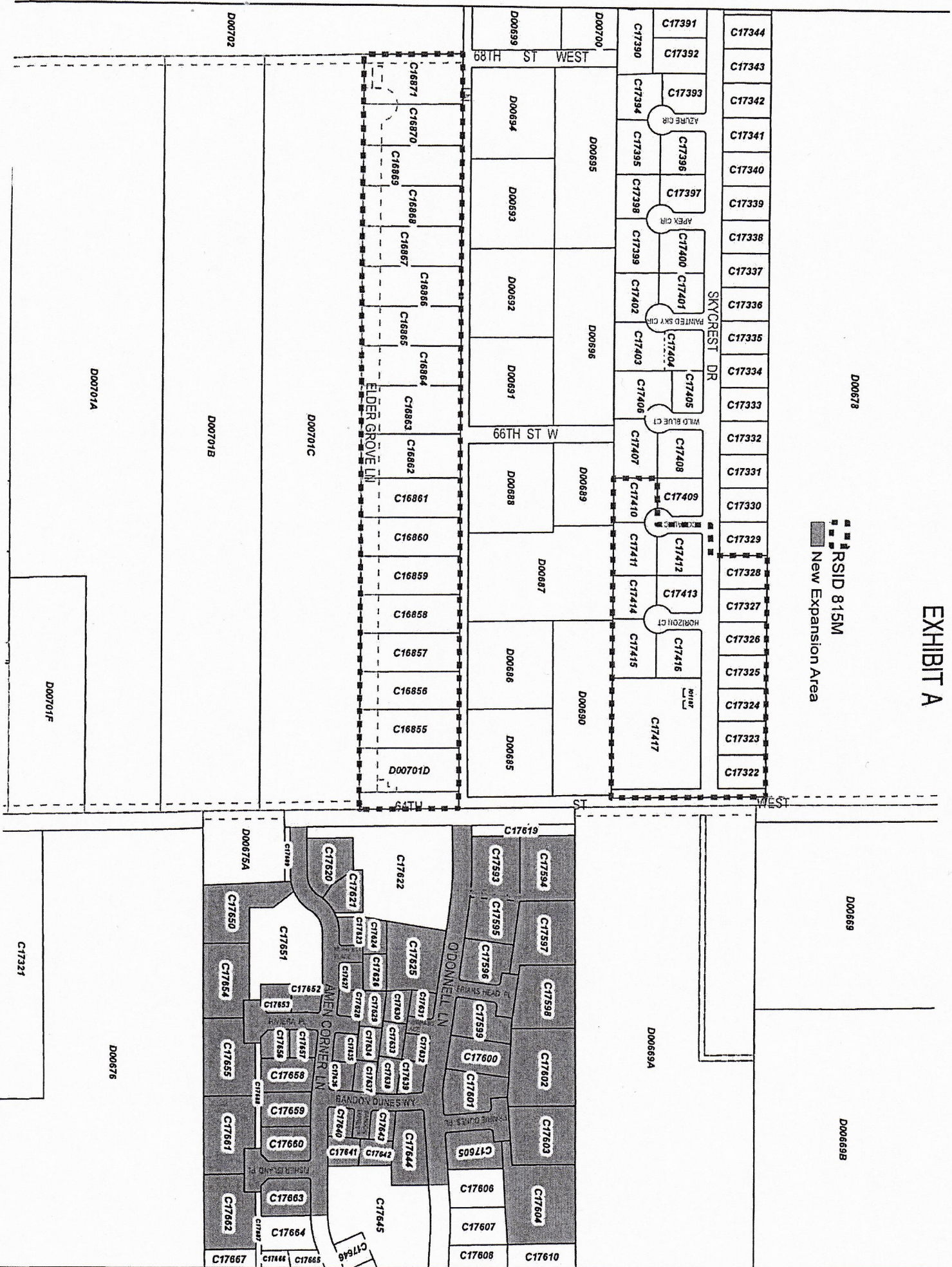

Tax ID	Owner Name
1 C16855	TOUNSLEY, JASON
2 C16856	WACASER, TODD S & BEVERLY
3 C16857	CRUZAN, NATHANIEL GEORGE &
4 C16858	RUSSELL, MAEL
5 C16859	COOK, PATRICK W & LANA D
6 C16860	LUNDE, NATHAN D & LARISSA S
7 C16861	BUSCH, ROBERT T & JANEY L
8 C16862	CALTON, TONI S
9 C16863	MURRAY, BARRY H & ANN J
10 C16864	SWEENEY, CHRISTOPHER & KIMBERLY
11 C16865	WORDEN, MICHAEL S & JULIE A
12 C16866	DAVIDSON, JOHN & BONNIE
13 C16867	FOSTER, NOLAN R & ANNIE C
14 C16868	CASTELLANO, KYLE E &
15 C16869	KNEPPER, WYATT & TERESA
16 C16870	LUNDIN, KEVIN
17 C16871	SMITH, JARRETT W & KAREN M
18 C17322	HAUGEN, MATTHEW E & TONYA K
19 C17323	ROMO, LUKE & ERIN
20 C17324	HUTCHINSON, COLTON & SHYLA
21 C17325	WAGENHALS, CHAD & ANGELA
22 C17326	WAGENHALS, CHAD & ANGELA
23 C17327	MCINTOSH, SPENCER THOMAS & SHAHINITA NICKOLE
24 C17328	LEONHARDT, BRIAN DAVID & NICOLE RAE
25 C17410	HOTZEL, LAWRENCE & LESLI
26 C17411	EBERLY, AARON & SOMMER
27 C17412	SMITH, RYAN E & ALISSA J
28 C17413	REGAL LAND DEVELOPMENT INC
29 C17414	MANSICH, STEVEN D & AMBER C
30 C17415	STORBAHL, DAVID & BRANDIE
31 C17416	RESTEMAYER, KEVIN & KELSEY
32 D00701D	DEWIT, JAMES L & SHARON

To be added to the existing RSID

33 C17593	P3COLEMAN LLC
34 C17594	JOHNSON, MARK R & SANDRA D
35 C17595	P3COLEMAN LLC
36 C17596	MURPHY, MALOREE
37 C17597	ERICKSON, MARK C & CHELSEA
38 C17598	WALTER, MELISSA A & CALVIN J
39 C17599	VISIONARY CUSTOM HOMES, LLC
40 C17600	P3COLEMAN LLC
41 C17601	BROSOVICH INVESTMENTS INC
42 C17602	BUTLER, THOMAS M & KATHY M
43 C17603	GUZMAN, GLENN & SUSAN
44 C17604	HOINESS, BRAVDON & KATRINA
45 C17605	P3COLEMAN LLC

Exhibit B

Tax ID	Owner Name	Mailing Address	City	ST	Zip	Legal Description
1 C16855	TOUNSLEY, JASON	6409 ELDER GROVE LN UNIT 4150 BOX 32	BILLINGS	MT	59106-2694	DEWIT SUB (15), S18, T01 S, R25 E, BLOCK 1, Lot 2
2 C16856	WACASER, TODD S & BEVERLY	1414 CHESAPEAKE LN	DPO	AP	96554-0032	DEWIT SUB (15), S18, T01 S, R25 E, BLOCK 1, Lot 3
3 C16857	CRUZAN, NATHANIEL GEORGE &	6501 ELDER GROVE LN	BILLINGS	MT	59101-8921	DEWIT SUB (15), S18, T01 S, R25 E, BLOCK 1, Lot 4
4 C16858	RUSSELL, MAEL	6507 ELDER GROVE LN	BILLINGS	MT	59106-2688	DEWIT SUB (15), S18, T01 S, R25 E, BLOCK 1, Lot 5
5 C16859	COOK, PATRICK W & LANA D	6513 ELDER GROVE LN	BILLINGS	MT	59106-2688	DEWIT SUB (15), S18, T01 S, R25 E, BLOCK 1, Lot 6
6 C16860	LUNDE, NATHAN D & LARISSA S	6519 ELDER GROVE LN	BILLINGS	MT	59106-2688	DEWIT SUB (15), S18, T01 S, R25 E, BLOCK 1, Lot 7
7 C16861	BUSCH, ROBERT T & JANEY L	6525 ELDER GROVE LN	BILLINGS	MT	59106-2688	DEWIT SUB (15), S18, T01 S, R25 E, BLOCK 1, Lot 8
8 C16862	CALTON, TONI S	6603 ELDER GROVE LN	BILLINGS	MT	59101-6028	DEWIT SUB (15), S18, T01 S, R25 E, BLOCK 1, Lot 9
9 C16863	MURRAY, BARRY H & ANN J	127 BURLINGTON AVE	BILLINGS	MT	59106-2672	DEWIT SUB (15), S18, T01 S, R25 E, BLOCK 1, Lot 10
10 C16864	SWEENEY, CHRISTOPHER & KIMBERLY	6615 ELDER GROVE LN	BILLINGS	MT	59106-2672	DEWIT SUB (15), S18, T01 S, R25 E, BLOCK 1, Lot 11
11 C16865	WORDEN, MICHAEL S & JULIE A	6621 ELDER GROVE LN	BILLINGS	MT	59106-2672	DEWIT SUB (15), S18, T01 S, R25 E, BLOCK 1, Lot 12
12 C16866	DAVIDSON, JOHN & BONNIE	6701 ELDER GROVE LN	BILLINGS	MT	59106-2678	DEWIT SUB (15), S18, T01 S, R25 E, BLOCK 1, Lot 13
13 C16867	FOSTER, NOLAN R & ANNIE C	2101 AVALON RD	BILLINGS	MT	59102-8014	DEWIT SUB (15), S18, T01 S, R25 E, BLOCK 1, Lot 14
14 C16868	CASTELLANO, KYLE E &	6713 ELDER GROVE LN	BILLINGS	MT	59106-2678	DEWIT SUB (15), S18, T01 S, R25 E, BLOCK 1, Lot 15
15 C16869	KNEPPER, WYATT & TERESA	6719 ELDER GROVE LN	BILLINGS	MT	59106-2678	DEWIT SUB (15), S18, T01 S, R25 E, BLOCK 1, Lot 16
16 C16870	LUNDIN, KEVIN	PO BOX 31141	BILLINGS	MT	59106-2678	DEWIT SUB (15), S18, T01 S, R25 E, BLOCK 1, Lot 17
17 C16871	SMITH, JARRETT W & KAREN M	6407 SKYCREST DR	BILLINGS	MT	59107-1141	DEWIT SUB (15), S18, T01 S, R25 E, BLOCK 1, Lot 18
18 C17322	HAUGEN, MATTHEW E & TONYA K	6415 SKYCREST DR	BILLINGS	MT	59106-3128	SKYCREST ESTATES SUB (19), S18, T01 S, R25 E, BLOCK 1, Lot 1
19 C17323	ROMO, LUKE & ERIN	6421 SKYCREST DR	BILLINGS	MT	59106-3128	SKYCREST ESTATES SUB (19), S18, T01 S, R25 E, BLOCK 1, Lot 2
20 C17324	HUTCHINSON, COLTON & SHYLA	3132 WESTERN BLUFFS BLVD	BILLINGS	MT	59106-3128	SKYCREST ESTATES SUB (19), S18, T01 S, R25 E, BLOCK 1, Lot 3
21 C17325	WAGENHALS, CHAD & ANGELA	6503 SKYCREST DR	BILLINGS	MT	59106-3128	SKYCREST ESTATES SUB (19), S18, T01 S, R25 E, BLOCK 1, Lot 4
22 C17326	WAGENHALS, CHAD & ANGELA	6509 SKYCREST DR	BILLINGS	MT	59106-3116	SKYCREST ESTATES SUB (19), S18, T01 S, R25 E, BLOCK 1, Lot 5
23 C17327	MCINTOSH, SPENCER THOMAS & SHAHINITA NICKOLE	1130 COBALT CT	BILLINGS	MT	59106-3116	SKYCREST ESTATES SUB (19), S18, T01 S, R25 E, BLOCK 1, Lot 6
24 C17328	LEONHARDT, BRIAN DAVID & NICOLE RAE	5236 FRONTIER DR	BILLINGS	MT	59106-3116	SKYCREST ESTATES SUB (19), S18, T01 S, R25 E, BLOCK 1, Lot 7
25 C17410	HOTZEL, LAWRENCE & LESLI	PO BOX 81445	BILLINGS	MT	59101-8918	SKYCREST ESTATES SUB (19), S18, T01 S, R25 E, BLOCK 1, Lot 8
26 C17411	EBERLY, AARON & SOMMER	PO BOX 81445	BILLINGS	MT	59101-8918	SKYCREST ESTATES SUB (19), S18, T01 S, R25 E, BLOCK 1, Lot 9
27 C17412	SMITH, RYAN E & ALISSA J	1130 HORIZON CT	BILLINGS	MT	59108-0445	SKYCREST ESTATES SUB (19), S18, T01 S, R25 E, BLOCK 4, Lot 21
28 C17413	REGAL LAND DEVELOPMENT INC	1129 HORIZON CT	BILLINGS	MT	59108-0445	SKYCREST ESTATES SUB (19), S18, T01 S, R25 E, BLOCK 4, Lot 22
29 C17414	MANSICH, STEVEN D & AMBER C	1121 HORIZON CT	BILLINGS	MT	59106-3114	SKYCREST ESTATES SUB (19), S18, T01 S, R25 E, BLOCK 4, Lot 23
30 C17415	STORBAHL, DAVID & BRANDIE	6403 ELDER GROVE LN	BILLINGS	MT	59106-3114	SKYCREST ESTATES SUB (19), S18, T01 S, R25 E, BLOCK 4, Lot 24
31 C17416	RESTEMAYER, KEVIN & KELSEY		BILLINGS	MT	59106-3114	SKYCREST ESTATES SUB (19), S18, T01 S, R25 E, BLOCK 4, Lot 25
32 D00701D	DEWIT, JAMES L & SHARON		BILLINGS	MT	59106-2694	DEWIT SUB (15), S18, T01 S, R25 E, BLOCK 4, Lot 26
			BILLINGS	MT	59106-2694	DEWIT SUB (15), S18, T01 S, R25 E, BLOCK 4, Lot 27

33 C17593	P3COLEMAN LLC	PO BOX 1555	BILLINGS	MT	59103-1555	THE NINES SUB (19), S17, T01 S, R25 E, BLOCK 1, Lot 1
34 C17594	JOHNSON, MARK R & SANDRA D	PO BOX 928	HARDIN	MT	59034-0928	THE NINES SUB (19), S17, T01 S, R25 E, BLOCK 1, Lot 2
35 C17595	P3COLEMAN LLC	PO BOX 1555	BILLINGS	MT	59103-1555	THE NINES SUB (19), S17, T01 S, R25 E, BLOCK 1, Lot 3
36 C17596	MURPHY, MALOREE	2615 CASTLE PINE CIR S	BILLINGS	MT	59101-9427	THE NINES SUB (19), S17, T01 S, R25 E, BLOCK 1, Lot 4
37 C17597	ERICKSON, MARK C & CHELSEA	1222 FRIARS HEAD PL	BILLINGS	MT	59106-3145	THE NINES SUB (19), S17, T01 S, R25 E, BLOCK 1, Lot 5
38 C17598	WALTER, MELISSA A & CALVIN J	1221 FRIARS HEAD PL	BILLINGS	MT	59106-3145	THE NINES SUB (19), S17, T01 S, R25 E, BLOCK 1, Lot 6
39 C17599	VISIONARY CUSTOM HOMES, LLC	6729 COVE CREEK DR	BILLINGS	MT	59106-2226	THE NINES SUB (19), S17, T01 S, R25 E, BLOCK 1, Lot 7
40 C17600	P3COLEMAN LLC	PO BOX 1555	BILLINGS	MT	59103-1555	THE NINES SUB (19), S17, T01 S, R25 E, BLOCK 1, Lot 8
41 C17601	BROSOVICH INVESTMENTS INC	4295 RANGEVIEW DR	BILLINGS	MT	59106-4738	THE NINES SUB (19), S17, T01 S, R25 E, BLOCK 1, Lot 9
42 C17602	BUTLER, THOMAS M & KATHY M	4525 RIO VISTA DR	BILLINGS	MT	59106-4732	THE NINES SUB (19), S17, T01 S, R25 E, BLOCK 1, Lot 10
43 C17603	GUZMAN, GLENN & SUSAN	2355 QUAIL CT	BILLINGS	MT	59106-4732	THE NINES SUB (19), S17, T01 S, R25 E, BLOCK 1, Lot 11
44 C17604	HOINESS, BRAVDON & KATRINA	626 CHERRY HILLS RD	BILLINGS	MT	59105-3655	THE NINES SUB (19), S17, T01 S, R25 E, BLOCK 1, Lot 12
45 C17605	P3COLEMAN LLC	PO BOX 1555	BILLINGS	MT	59103-1555	THE NINES SUB (19), S17, T01 S, R25 E, BLOCK 1, Lot 13

